

Tuscarawas County, Ohio

Parcel: 25-00789-000

SUMMARY

Owner	BERTONI LOUIS E 4496 MAPLEVIEW DRIVE VERMILLION OH 44089 USA	Taxpayer	BERTONI LOUIS E 4496 MAPLEVIEW DRIVE VERMILLION OH 44089 USA
Tax District	25-GOSHEN TWP-NEW PHILADELPHIA SD	Class	511-1-FAMILY UNPLATTED 0-09.99 ACS
School District	NEW PHIL. SD	Subdivision	
Location	1560 SEVEN MILE DR	Legal	2 9 4 VINTON LD 5 02A
CD Year		Map # / Routing #	2 01 / 9000
Ag Year		Acres	5.020
Sales Amount		Sold	05/09/2016
		Volume	1502
		Page	1937

CHARGE

	Prior	1st Half	2nd Half	Total
Tax	1,852.52	1,505.31	1,655.84	5,013.67
Special	3.63	3.00	3.30	9.93
Total	1,856.15	1,508.31	1,659.14	5,023.60
Paid	1,856.15	1,508.31	1,659.14	5,023.60
Due	0.00	0.00	0.00	0.00
Escrow				0.00

VALUE

	Appraised	Assessed
Land	71,110	24,890
Improvement	109,590	38,360
Total	180,700	63,250
CAUV	0	0
Homestead	N	
OOC	N	0

TRANSFER HISTORY

Date	Buyer	Conveyance	Deed Type	Land Only	Sales Amount	Valid
05/09/2016	BERTONI LOUIS E	900696	AFFIDAVIT TOD DESIGNATION	N	\$0	N
03/23/2005	BERTONI LOUIS	90374	AFFIDAVIT	N	\$0	N
02/07/1995	MCMILLEN NANCY & LOUIS E BERTO	296	JOINT SURVIVORSHIP	N	\$0	N

LAND

Type	Dimensions	Description	Value
HS-HOMESITE	1.000	Acres	50,000
RS-RESIDUAL	4.020	Acres	21,110

DWELLING

Card 1	Style	23-LOG HOME	Family Rooms	0	Heating	Y
	Stories	1.00	Dining Rooms	0	Cooling	N
	Rec Room Area	625	Year Built	1986	Grade	C+6
	Finished Basement	0	Year Remodeled		Fireplace Openings	1
	Rooms	4	Full Baths	1	Fireplace Stacks	1
	Bed Rooms	2	Half Baths	0	Living Area	1,544
			Other Fixtures	0	Appraised Value	108,320

OTHER IMPROVEMENT

Card	Description	Yr Blt	Yr Rem	Size	Condition	Value
1	SHED-SHED	1994		144	GOOD	1,270

UTILITIES

Water	N	Sewer	N	Electric	N	Gas	N	Well	N	Septic	N
-------	---	-------	---	----------	---	-----	---	------	---	--------	---

SKETCH

Card 1

Name	Description	Size
1	SHED-SHED	144
A	1SFR/B/2CBSG	1,544
B	OFF	256
C	OFF	32

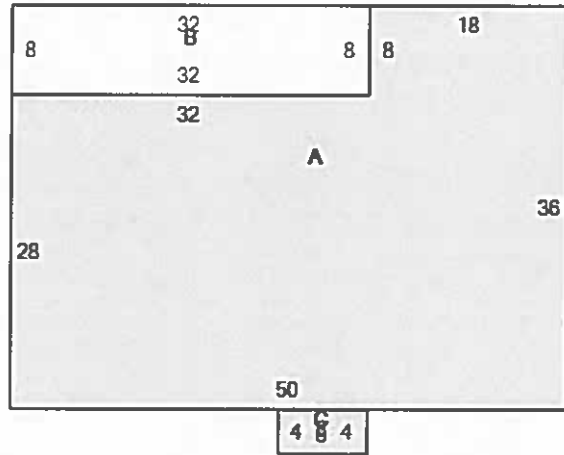

[1]



RESIDENTIAL PROPERTY DISCLOSURE FORM

Purpose of Disclosure Form: This is a statement of certain conditions and information concerning the property actually known by the owner. An owner may or may not have lived at the property and unless the potential purchaser is informed in writing, the owner has no more information about the property than could be obtained by a careful inspection of the property by a potential purchaser. Unless the potential purchaser is otherwise informed, the owner has not conducted any inspection of generally inaccessible areas of the property. This form is required by Ohio Revised Code Section 5302.30.

THIS FORM IS NOT A WARRANTY OF ANY KIND BY THE OWNER OR BY ANY AGENT OR SUBAGENT REPRESENTING THE OWNER. THIS FORM IS NOT A SUBSTITUTE FOR ANY INSPECTIONS. POTENTIAL PURCHASERS ARE ENCOURAGED TO OBTAIN THEIR OWN PROFESSIONAL INSPECTION(S).

Owner's Statement: The statements contained in this form are made by the owner and are not the statements of the owner's agent or subagent. The statements contained in this form are provided by the owner only to potential purchasers in a transfer made by the owner. The statements are not for purchasers in any subsequent transfers. The information contained in this disclosure form does not limit the obligation of the owner to disclose an item of information that is required by any other statute or law to be disclosed in the transfer of residential real estate.

OWNER INSTRUCTIONS

Instructions to Owner: (1) Answer ALL questions. (2) Report known conditions affecting the property. (3) Attach additional pages with your signature if additional space is needed. (4) Complete this form yourself. (5) If some items do not apply to your property, write NA (not applicable). If the item to be disclosed is not within your actual knowledge, indicate Unknown.

Owner's Initials AR Date 10/18/16
Owner's Initials _____ Date _____

Purchaser's Initials _____ Date _____
Purchaser's Initials _____ Date _____



STATE OF OHIO DEPARTMENT OF COMMERCE

RESIDENTIAL PROPERTY DISCLOSURE FORM

Pursuant to section 5302.30 of the Revised Code and rule 1301:5-6-10 of the Administrative Code.

TO BE COMPLETED BY OWNER (Please Print)

Property Address:

Owners Name(s):

Date: _____, 20____

Owner is is not occupying the property. If owner is occupying the property, since what date: _____

If owner is not occupying the property, since what date: _____

OWNER HAS NEVER LIVED IN PROPERTY

THE FOLLOWING STATEMENTS OF THE OWNER ARE BASED ON OWNER'S ACTUAL KNOWLEDGE

A) WATER SUPPLY: The source of water supply to the property is (check appropriate boxes):

- Public Water Service, Private Water Service, Private Well, Shared Well, Holding Tank, Cistern, Spring, Pond, Unknown, Other

Do you know of any current leaks, backups or other material problems with the water supply system or quality of the water? Yes No

Is the quantity of water sufficient for your household use? (NOTE: water usage will vary from household to household) Yes No

B) SEWER SYSTEM: The nature of the sanitary sewer system servicing the property is (check appropriate boxes):

- Public Sewer, Leach Field, Unknown, Private Sewer, Aeration Tank, Other, Septic Tank, Filtration Bed

If not a public or private sewer, date of last inspection: _____ Inspected By: _____

Do you know of any previous or current leaks, backups or other material problems with the sewer system servicing the property?

Yes No If "Yes", please describe and indicate any repairs completed (but not longer than the past 5 years): _____

Information on the operation and maintenance of the type of sewage system serving the property is available from the department of health or the board of health of the health district in which the property is located.

C) ROOF: Do you know of any previous or current leaks or other material problems with the roof or rain gutters? Yes No

UNKNOWN

D) WATER INTRUSION: Do you know of any previous or current water leakage, water accumulation, excess moisture or other defects to the property, including but not limited to any area below grade, basement or crawl space? Yes No

If "Yes", please describe and indicate any repairs completed: _____

UNKNOWN

Owner's Initials AB Date 10/18/14

Purchaser's Initials _____ Date _____

Property Address 1560 Seven Mile Dr. New Philadelphia, OH 44663

Do you know of any water or moisture related damage to floors, walls or ceilings as a result of flooding; moisture seepage; moisture condensation; ice damming; sewer overflow/backup; or leaking pipes, plumbing fixtures, or appliances? Yes No
If "Yes", please describe and indicate any repairs completed: UNKNOWN

Have you ever had the property inspected for mold by a qualified inspector? Yes No
If "Yes", please describe and indicate whether you have an inspection report and any remediation undertaken: UNKNOWN

Purchaser is advised that every home contains mold. Some people are more sensitive to mold than others. If concerned about this issue, purchaser is encouraged to have a mold inspection done by a qualified inspector.

E) STRUCTURAL COMPONENTS (FOUNDATION, BASEMENT/CRAWL SPACE, FLOORS, INTERIOR AND EXTERIOR WALLS): Do you know of any previous or current movement, shifting, deterioration, material cracks/settling (other than visible minor cracks or blemishes) or other material problems with the foundation, basement/crawl space, floors, or interior/exterior walls?
 Yes No If "Yes", please describe and indicate any repairs, alterations or modifications to control the cause or effect of any problem identified (but not longer than the past 5 years): UNKNOWN

Do you know of any previous or current fire or smoke damage to the property? Yes No
If "Yes", please describe and indicate any repairs completed: UNKNOWN

F) WOOD DESTROYING INSECTS/TERMITES: Do you know of any previous/current presence of any wood destroying insects/termites in or on the property or any existing damage to the property caused by wood destroying insects/termites? Yes No
If "Yes", please describe and indicate any inspection or treatment (but not longer than the past 5 years):

G) MECHANICAL SYSTEMS: Do you know of any previous or current problems or defects with the following existing mechanical systems? If your property does not have the mechanical system, mark N/A (Not Applicable).

	YES	NO	N/A		YES	NO	N/A
1) Electrical	<input type="checkbox"/>	<input type="checkbox"/>	<input type="checkbox"/>	8) Water softener	<input type="checkbox"/>	<input type="checkbox"/>	<input type="checkbox"/>
2) Plumbing (pipes)	<input type="checkbox"/>	<input type="checkbox"/>	<input type="checkbox"/>	a. Is water softener leased?	<input type="checkbox"/>	<input type="checkbox"/>	<input type="checkbox"/>
3) Central heating	<input type="checkbox"/>	<input type="checkbox"/>	<input type="checkbox"/>	9) Security System	<input type="checkbox"/>	<input type="checkbox"/>	<input type="checkbox"/>
4) Central Air conditioning	<input type="checkbox"/>	<input type="checkbox"/>	<input type="checkbox"/>	a. Is security system leased?	<input type="checkbox"/>	<input type="checkbox"/>	<input type="checkbox"/>
5) Sump pump	<input type="checkbox"/>	<input type="checkbox"/>	<input type="checkbox"/>	10) Central vacuum	<input type="checkbox"/>	<input type="checkbox"/>	<input type="checkbox"/>
6) Fireplace/chimney	<input type="checkbox"/>	<input type="checkbox"/>	<input type="checkbox"/>	11) Built in appliances	<input type="checkbox"/>	<input type="checkbox"/>	<input type="checkbox"/>
7) Lawn sprinkler	<input type="checkbox"/>	<input type="checkbox"/>	<input type="checkbox"/>	12) Other mechanical systems	<input type="checkbox"/>	<input type="checkbox"/>	<input type="checkbox"/>

If the answer to any of the above questions is "Yes", please describe and indicate any repairs to the mechanical system (but not longer than the past 5 years): UNKNOWN

H) PRESENCE OF HAZARDOUS MATERIALS: Do you know of the previous or current presence of any of the below identified hazardous materials on the property?

	Yes	No	Unknown
1) Lead-Based Paint	<input type="checkbox"/>	<input checked="" type="checkbox"/>	<input type="checkbox"/>
2) Asbestos	<input type="checkbox"/>	<input checked="" type="checkbox"/>	<input type="checkbox"/>
3) Urea-Formaldehyde Foam Insulation	<input type="checkbox"/>	<input checked="" type="checkbox"/>	<input type="checkbox"/>
4) Radon Gas	<input type="checkbox"/>	<input checked="" type="checkbox"/>	<input type="checkbox"/>
a. If "Yes", indicate level of gas if known			
5) Other toxic or hazardous substances	<input type="checkbox"/>	<input checked="" type="checkbox"/>	<input type="checkbox"/>

If the answer to any of the above questions is "Yes", please describe and indicate any repairs, remediation or mitigation to the property:

Owner's Initials AB Date 10/18/16
Owner's Initials _____ Date _____

Purchaser's Initials _____ Date _____
Purchaser's Initials _____ Date _____

Property Address 1560 Seven Mile Dr. New Philadelphia OH 44662

I) UNDERGROUND STORAGE TANKS/WELLS: Do you know of any underground storage tanks (existing or removed), oil or natural gas wells (plugged or unplugged), or abandoned water wells on the property? Yes No
If "Yes", please describe: _____

Do you know of any oil, gas, or other mineral right leases on the property? Yes No

Purchaser should exercise whatever due diligence purchaser deems necessary with respect to oil, gas, and other mineral rights. Information may be obtained from records contained within the recorder's office in the county where the property is located.

J) FLOOD PLAIN/LAKE ERIE COASTAL EROSION AREA:
Is the property located in a designated flood plain? Yes No Unknown
Is the property or any portion of the property included in a Lake Erie Coastal Erosion Area? Yes No Unknown

K) DRAINAGE/EROSION: Do you know of any previous or current flooding, drainage, settling or grading or erosion problems affecting the property? Yes No
If "Yes", please describe and indicate any repairs, modifications or alterations to the property or other attempts to control any problems (but not longer than the past 5 years): UNKOWN

L) ZONING/CODE VIOLATIONS/ASSESSMENTS/HOMEOWNERS' ASSOCIATION: Do you know of any violations of building or housing codes, zoning ordinances affecting the property or any nonconforming uses of the property? Yes No
If "Yes", please describe: UNKOWN

Is the structure on the property designated by any governmental authority as a historic building or as being located in an historic district? (NOTE: such designation may limit changes or improvements that may be made to the property). Yes No
If "Yes", please describe: UNKOWN

Do you know of any recent or proposed assessments, fees or abatements, which could affect the property? Yes No
If "Yes", please describe: UNKOWN

List any assessments paid in full (date/amount) _____
List any current assessments: _____ monthly fee _____ Length of payment (years _____ months _____)

Do you know of any recent or proposed rules or regulations of, or the payment of any fees or charges associated with this property, including but not limited to a Community Association, SID, CID, LID, etc. Yes No
If "Yes", please describe (amount) _____

M) BOUNDARY LINES/ENCROACHMENTS/SHARED DRIVEWAY/PARTY WALLS: Do you know of any of the following conditions affecting the property? Yes No Yes No
1) Boundary Agreement 4) Shared Driveway
2) Boundary Dispute 5) Party Walls
3) Recent Boundary Change 6) Encroachments From or on Adjacent Property
If the answer to any of the above questions is "Yes", please describe: _____

N) OTHER KNOWN MATERIAL DEFECTS: The following are other known material defects in or on the property: None

For purposes of this section, material defects would include any non-observable physical condition existing on the property that could be dangerous to anyone occupying the property or any non-observable physical condition that could inhibit a person's use of the property.

Owner's Initials AB Date 10/13/14
Owner's Initials _____ Date _____

Purchaser's Initials _____ Date _____
Purchaser's Initials _____ Date _____

Property Address 1560 Seven Mile Dr. New Philadelphia, OH 44663

CERTIFICATION OF OWNER

Owner certifies that the statements contained in this form are made in good faith and based on his/her actual knowledge as of the date signed by the Owner. Owner is advised that the information contained in this disclosure form does not limit the obligation of the owner to disclose an item of information that is required by any other statute or law or that may exist to preclude fraud, either by misrepresentation, concealment or nondisclosure in a transaction involving the transfer of residential real estate.

OWNER: Andrea Butty, POA DATE: 10/18/16
OWNER: Louis Bertoni DATE: _____

RECEIPT AND ACKNOWLEDGEMENT OF POTENTIAL PURCHASERS

Potential purchasers are advised that the owner has no obligation to update this form but may do so according to Revised Code Section 5302.30(G). Pursuant to Ohio Revised Code Section 5302.30(K), if this form is not provided to you prior to the time you enter into a purchase contract for the property, you may rescind the purchase contract by delivering a signed and dated document of rescission to Owner or Owner's agent, provided the document of rescission is delivered prior to all three of the following dates: 1) the date of closing; 2) 30 days after the Owner accepted your offer; and 3) within 3 business days following your receipt or your agent's receipt of this form or an amendment of this form.

Owner makes no representations with respect to any offsite conditions. Purchaser should exercise whatever due diligence purchaser deems necessary with respect to offsite issues that may affect purchaser's decision to purchase the property.

Purchaser should exercise whatever due diligence purchaser deems necessary with respect to Ohio's Sex Offender Registration and Notification Law (commonly referred to as "Megan's Law"). This law requires the local Sheriff to provide written notice to neighbors if a sex offender resides or intends to reside in the area. The notice provided by the Sheriff is a public record and is open to inspection under Ohio's Public Records Law. If concerned about this issue, purchaser assumes responsibility to obtain information from the Sheriff's office regarding the notices they have provided pursuant to Megan's Law.

Purchaser should exercise whatever due diligence purchaser deems necessary with respect to abandoned underground mines. If concerned about this issue, purchaser assumes responsibility to obtain information from the Ohio Department of Natural Resources. The Department maintains an online map of known abandoned underground mines on their website at www.dnr.state.oh.us.

I/WE ACKNOWLEDGE RECEIPT OF A COPY OF THIS DISCLOSURE FORM AND UNDERSTAND THAT THE STATEMENTS ARE MADE BASED ON THE OWNERS ACTUAL KNOWLEDGE AS OF THE DATE SIGNED BY THE OWNER.

My/Our Signature below does not constitute approval of any disclosed condition as represented herein by the owner.

PURCHASER: _____ DATE: _____
PURCHASER: _____ DATE: _____