

Don R. Wallick Auctions, Inc.

965 N. Wooster Avenue - Strasburg, Ohio 44680 - www.WallickAuctions.com
 Toll Free: 1-866-348-9446 - Tel: 330-878-0075 - Fax: 330-878-7318



Property Record Card - Alan Harold, Stark County Auditor

Generated 4/23/2015 4:17:23 PM

Subject Property	
Parcel	6900467
Owner	SLAYMAN DOROTHY J
Address	318 2ND AVE SW OH
Mailing Address Line 1	SLAYMAN DOROTHY J
Mailing Address Line 2	PO BOX 42
Mailing Address Line 3	BEACH CITY OH 44608
Legal Description	OL 1 .34A
Use Imposed	09080009
Property Class	RESIDENTIAL
DTE Classification	510 - 1-FAMILY DWELLING
Tax District	00860 SUGARCREEK TWP - BEACH CITY VILLAGE - FAIRLESS LSD
School District	7604 FAIRLESS LSD
Township	SUGARCREEK TOWNSHIP
City	BEACH CITY VILLAGE
Neighborhood	065-00-00-01
Map Routing Number	69 004 12 0700

Allotments	
Allotment	Lot
No Allotment Information Available	

Valuation Details						
Year	Appraised Land Value	Assessed Land Value	Appraised Building Value	Assessed Building Value	Appraised Total Value	Assessed Total Value
2014	\$18,200	\$5,670	\$71,100	\$24,850	\$87,300	\$30,560
2013	\$18,200	\$5,670	\$71,100	\$24,850	\$87,300	\$30,560
2012	\$18,200	\$5,670	\$71,100	\$24,850	\$87,300	\$30,560
2011	\$18,100	\$5,340	\$70,600	\$24,710	\$88,700	\$31,050
2010	\$18,100	\$5,340	\$70,600	\$24,710	\$88,700	\$31,050
2009	\$18,100	\$5,340	\$70,600	\$24,710	\$88,700	\$31,050
2008	\$20,500		\$68,800		\$90,400	\$31,640

Land Details								
Description	Acreage	Frontage	Depth	Area (sqft)	Method	Rate	Adj %	Value
ROADWAY		0	0	0	FF	\$0.00	0	\$0
HOUSE LOT		99	150	14,850	FF	\$180.00	25	\$18,200

Sales Details						
Date	Work Order Number	Work Order Year	Number Of Parcels	Arm Length	Sale Price	Taxable Value
11/14/2008	12543	2008	0	NO	\$0	\$31,650

Details for Primary Building 777726					
Building Type	11 - RANCH	Construction Type	2 - BRICK	Full Baths	2
Year Built	1963	Quality Basement Finish	0 - NONE	Half Baths	0
Number Of Stories	1.00	Percent Complete	100	Basement	1 - FULL
Condition	2 - GOOD	Heat Type	GAS	Number Of Fireplaces	0
Living Area	1312	Central Air	YES	Family Room	NO
Quality Grade	100	Number Of Bedrooms	3	Primary Value	\$71,100

Data For Parcel 6900467

If you have any questions regarding the actual payments on this parcel, please call the Treasurer's office at 330-451-7814.
 Check previous years' taxes on the Stark County Treasurer's site.
 Use the Stark County Tax Estimator.

Tax Data

Parcel:	6900467
Owner:	SLAYMAN DOROTHY J
Site Address:	319 2ND AVE SW OH
Map Routing Number:	69 004 12 0700
Tax Map:	BC_909.pdf



[\(-\) Map this property.](#)

Tax Information - Data as of 4/18/2015 4:04:14 AM

Bill Number:	20147047500	Installment Number:	2
Taxable Land Value:	\$5,670	Taxable Building Value:	\$24,990
Owner Occupancy Discount:	YES	Homestead Reduction:	YES
CAUV Recoupment:	N/A	Recoupment Amount:	
Homestead Deduction:	\$8,750	Tax Abatement:	NO
Owner Occupancy Qualified Value:	\$30,550	Property Destruction:	NO
Homestead Deduction Year:		Agricultural Use Value:	NO
Tax Year:	2014		

Tax Billing - Data as of 4/18/2015 4:04:14 AM

Section	Label	Billed	Paid	Balance	Delinquent Date
1st Half:	Real Estate Tax	1,208.66			
	Tax Reduction	-280.87			
	Non-Business Credit (.1)	-82.78			
	Owner Occupancy Credit (.025)	-23.19			
	Homestead Reduction	-232.44			
	_ Net Tax:	579.37	579.37	.00	
_ Total 1st Half:		579.37	579.37	.00	
2nd Half:	Real Estate Tax	1,208.66			
	Tax Reduction	-280.87			
	Non-Business Credit (.1)	-82.78			
	Owner Occupancy Credit (.025)	-23.19			
	Homestead Reduction	-232.44			
	_ Net Tax:	579.37	.00	579.37	
_ Total 2nd Half:		579.37	.00	579.37	
Total:		1,158.74	579.37	579.37	

Tax Payments - Data as of 4/18/2015 4:04:14 AM









Payment Date	Payment Half	Payment Amount
02/05/2015	1	\$579.37

Special Assessments - Data as of 4/18/2015 3:01:10 AM

No data found for this parcel.



Scale: 5ft

	G1BR
	528 sqft
	Z1BR
	126 sqft
	O1BR
	72 sqft
	11
	1312 sqft
	D1BR
	20 sqft

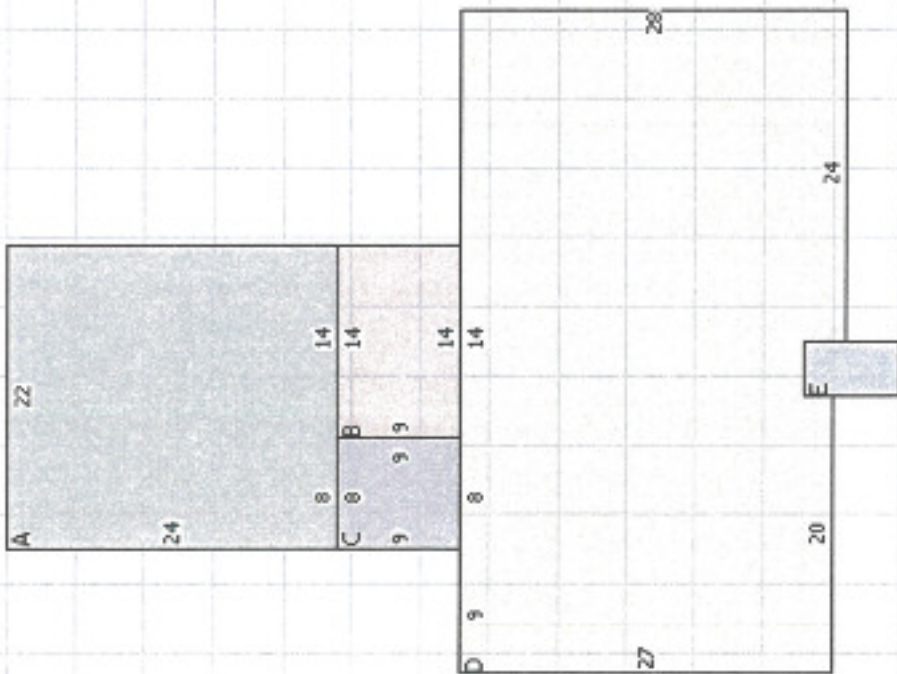

6900467 Building ID 7777726

Property Record Card - Alan Harold, Stark County Auditor

Generated 4/20/2015 4:20:37 PM

Subject Property	
Parcel	6900468
Owner	SLAYMAN DOROTHY J
Address	2ND AVE SW OH
Mailing Address Line 1	SLAYMAN DOROTHY J
Mailing Address Line 2	PO BOX 42
Mailing Address Line 3	BEACH CITY OH 44608
Legal Description	OL 1 .34 A SEC 35 PSE
Last Inspected	08/30/2009
Property Class	RESIDENTIAL
DTE Classification	599 - OTHER RESIDENTIAL STRUCTURES
Tax District	00660 SUGARCREEK TWP - BEACH CITY VILLAGE - FAIRLESS LSD
School District	7604 FAIRLESS LSD
Township	SUGARCREEK TOWNSHIP
City	BEACH CITY VILLAGE
Neighborhood	066-00-00-01
Map Routing Number	69 004 12 0600

Allotments	
Allotment	Lot
No Allotment Information Available	

Valuation Details						
Year	Appraised Land Value	Assessed Land Value	Appraised Building Value	Assessed Building Value	Appraised Total Value	Assessed Total Value
2014	\$8,700	\$3,050	\$9,500	\$3,330	\$18,200	\$6,380
2013	\$8,700	\$3,050	\$9,500	\$3,330	\$18,200	\$6,380
2012	\$8,700	\$3,050	\$9,500	\$3,330	\$18,200	\$6,380
2011	\$9,800	\$3,430	\$8,200	\$2,870	\$18,000	\$6,300
2010	\$9,800	\$3,430	\$8,200	\$2,870	\$18,000	\$6,300
2009	\$9,800	\$3,430	\$8,200	\$2,870	\$18,000	\$6,300
2008	\$12,200		\$8,200		\$20,400	\$7,140

Land Details								
Description	Acreage	Frontage	Depth	Area (sqft)	Method	Rate	Adj %	Value
EXCESS LAND		100	150	15,000	FF	\$180.00	60	\$8,700

Sales Details						
Date	Work Order Number	Work Order Year	Number Of Parcels	Arms Length	Sale Price	Taxable Value
11/14/2008	12843	2008	0	NO	\$0	\$7,140

Details for Improvement 6369433					
Building Type	140 - GARAGE	Adjustment Percent	0	Year Built	1991
Number Of Stories	1.0	Value	9,500	Reason	-
Frontage	30.00	Common Walls	0	Condition	GOOD
Depth	40	Construction Type	POLE	Grade	100
Area (sqft)	1,200	Height	0	Value	9,500

Data For Parcel 6900468

If you have any questions regarding the actual payments on this parcel, please call the Treasurer's office at 330-451-7814.
[Check previous years' taxes on the Stark County Treasurer's site.](#)
[Use the Stark County Tax Estimator.](#)

Tax Data

Parcel:	6900468
Owner:	SLAYMAN DOROTHY J
Site Address:	2ND AVE SW/CH
Map Routing Number:	69 004 12 CB02
Tax Map:	BC_009.sdf



[\(+\)](#) Map this property.

Tax Information - Data as of 4/18/2015 4:04:14 AM

Bill Number:	20147854000	Installment Number:	2
Taxable Land Value:	\$3,050	Taxable Building Value:	\$3,330
Owner Occupancy Discount:	NO	Homestead Reduction:	NO
CAUV Recoupment:	N/A	Recoupment Amount:	
Homestead Deduction:		Tax Abatement:	NO
Owner Occupancy Qualified Value:		Property Destruction:	NO
Homestead Deduction Year:		Agricultural Use Value:	NO
Tax Year:	2014		

Tax Billing - Data as of 4/18/2015 4:04:14 AM

Section	Label	Billed	Paid	Balance	Delinquent Date
1st Half:	Real Estate Tax	252.33			
	Tax Reduction	-58.64			
	Non-Business Credit (.1)	-19.37			
	_ Net Tax:	174.32	174.32	.00	
	27-MUSKINGUM WATERSHED	3.00	3.00	.00	
	_ Total 1st Half:	177.32	177.32	.00	
2nd Half:	Real Estate Tax	252.33			
	Tax Reduction	-58.64			
	Non-Business Credit (.1)	-19.37			
	_ Net Tax:	174.32	.00	174.32	
	27-MUSKINGUM WATERSHED	3.00	.00	3.00	
	_ Total 2nd Half:	177.32	.00	177.32	
	Total:	354.64	177.32	177.32	

Tax Payments - Data as of 4/18/2015 4:04:14 AM

Payment Date	Payment Half	Payment Amount
02/05/2015	1	\$177.32

Special Assessments - Data as of 4/18/2015 3:01:10 AM

Agency	Code	StandardAmount	Status	Type	Balance
MUSKINGUM WCD	27 - MUSKINGUM WATERSHED	\$3.00	ACTIVE	SEMI-ANNUAL FIXED	\$3.00
MUSKINGUM WCD	27 - MUSKINGUM WATERSHED	\$0.00	PAID IN FULL	SEMI-ANNUAL FIXED	\$0.00





STATE OF OHIO
DEPARTMENT OF COMMERCE

2013

319 2nd Ave SW Beach City

RESIDENTIAL PROPERTY DISCLOSURE FORM

P.O.A. Has Never lived in this property

Purpose of Disclosure Form: This is a statement of certain conditions and information concerning the property actually known by the owner. An owner may or may not have lived at the property and unless the potential purchaser is informed in writing, the owner has no more information about the property than could be obtained by a careful inspection of the property by a potential purchaser. Unless the potential purchaser is otherwise informed, the owner has not conducted any inspection of generally inaccessible areas of the property. This form is required by Ohio Revised Code Section 5302.30.

THIS FORM IS NOT A WARRANTY OF ANY KIND BY THE OWNER OR BY ANY AGENT OR SUBAGENT REPRESENTING THE OWNER. THIS FORM IS NOT A SUBSTITUTE FOR ANY INSPECTIONS. POTENTIAL PURCHASERS ARE ENCOURAGED TO OBTAIN THEIR OWN PROFESSIONAL INSPECTION(S).

Owner's Statement: The statements contained in this form are made by the owner and are not the statements of the owner's agent or subagent. The statements contained in this form are provided by the owner only to potential purchasers in a transfer made by the owner. The statements are not for purchasers in any subsequent transfers. The information contained in this disclosure form does not limit the obligation of the owner to disclose an item of information that is required by any other statute or law to be disclosed in the transfer of residential real estate.

OWNER INSTRUCTIONS

Instructions to Owner: (1) Answer ALL questions. (2) Report known conditions affecting the property. (3) Attach additional pages with your signature if additional space is needed. (4) Complete this form yourself. (5) If some items do not apply to your property, write NA (not applicable). If the item to be disclosed is not within your actual knowledge, indicate Unknown.

Owner's Initials JM Date 3/18/15
Owner's Initials _____ Date _____

Purchaser's Initials _____ Date _____
Purchaser's Initials _____ Date _____



2013

STATE OF OHIO DEPARTMENT OF COMMERCE

RESIDENTIAL PROPERTY DISCLOSURE FORM

Pursuant to section 5302.30 of the Revised Code and rule 1301:5-6-10 of the Administrative Code.

TO BE COMPLETED BY OWNER (Please Print)

Property Address: 319 2nd Ave SW BEAHCITY

Owners Name(s): Dorothy J. Slayman / John Miller P.O.A.

Date: 3-19-2015

Owner is not occupying the property. If owner is occupying the property, since what date: 3-15-15

THE FOLLOWING STATEMENTS OF THE OWNER ARE BASED ON OWNER'S ACTUAL KNOWLEDGE

A) WATER SUPPLY: The source of water supply to the property is (check appropriate boxes):

- Public Water Service, Private Water Service, Private Well, Shared Well, Holding Tank, Cistern, Spring, Pond, Unknown, Other

Do you know of any current leaks, backups or other material problems with the water supply system or quality of the water? No

Is the quantity of water sufficient for your household use? Yes

B) SEWER SYSTEM: The nature of the sanitary sewer system servicing the property is (check appropriate boxes):

- Public Sewer, Private Sewer, Septic Tank, Leach Field, Aeration Tank, Filtration Bed, Unknown, Other

If not a public or private sewer, date of last inspection: Inspected By:

Do you know of any previous or current leaks, backups or other material problems with the sewer system servicing the property? No

Information on the operation and maintenance of the type of sewage system serving the property is available from the department of health or the board of health of the health district in which the property is located.

C) ROOF: Do you know of any previous or current leaks or other material problems with the roof or rain gutters? No

D) WATER INTRUSION: Do you know of any previous or current water leakage, water accumulation, excess moisture or other defects to the property, including but not limited to any area below grade, basement or crawl space? No

Owner's Initials JM Date 3/19/15

Purchaser's Initials Date

POA Has Never Lived in this property

Property Address 319 2nd Ave SW Peach City

Do you know of any water or moisture related damage to floors, walls or ceilings as a result of flooding; moisture seepage; moisture condensation; ice damming; sewer overflow/backlog; or leaking pipes, plumbing fixtures, or appliances? Yes No
If "Yes", please describe and indicate any repairs completed: _____

Have you ever had the property inspected for mold by a qualified inspector? Yes No
If "Yes", please describe and indicate whether you have an inspection report and any remediation undertaken: _____

Purchaser is advised that every home contains mold. Some people are more sensitive to mold than others. If concerned about this issue, purchaser is encouraged to have a mold inspection done by a qualified inspector.

E) STRUCTURAL COMPONENTS (FOUNDATION, BASEMENT/CRAWL SPACE, FLOORS, INTERIOR AND EXTERIOR WALLS): Do you know of any previous or current movement, shifting, deterioration, material cracks/settling (other than visible minor cracks or blemishes) or other material problems with the foundation, basement/crawl space, floors, or interior/exterior walls?
 Yes No If "Yes", please describe and indicate any repairs, alterations or modifications to control the cause or effect of any problem identified (but not longer than the past 5 years): _____

Do you know of any previous or current fire or smoke damage to the property? Yes No
If "Yes", please describe and indicate any repairs completed: _____

F) WOOD DESTROYING INSECTS/TERMITES: Do you know of any previous/current presence of any wood destroying insects/termites in or on the property or any existing damage to the property caused by wood destroying insects/termites? Yes No
If "Yes", please describe and indicate any inspection or treatment (but not longer than the past 5 years): _____

G) MECHANICAL SYSTEMS: Do you know of any previous or current problems or defects with the following existing mechanical systems? If your property does not have the mechanical system, mark N/A (Not Applicable).

	YES	NO	N/A		YES	NO	N/A
1) Electrical	<input type="checkbox"/>	<input checked="" type="checkbox"/>	<input type="checkbox"/>	8) Water softener	<input type="checkbox"/>	<input type="checkbox"/>	<input checked="" type="checkbox"/>
2) Plumbing (pipes)	<input type="checkbox"/>	<input checked="" type="checkbox"/>	<input type="checkbox"/>	a. Is water softener leased?	<input type="checkbox"/>	<input type="checkbox"/>	<input checked="" type="checkbox"/>
3) Central heating	<input type="checkbox"/>	<input checked="" type="checkbox"/>	<input type="checkbox"/>	9) Security System	<input type="checkbox"/>	<input type="checkbox"/>	<input checked="" type="checkbox"/>
4) Central Air conditioning	<input type="checkbox"/>	<input checked="" type="checkbox"/>	<input type="checkbox"/>	a. Is security system leased?	<input type="checkbox"/>	<input type="checkbox"/>	<input checked="" type="checkbox"/>
5) Sump pump	<input type="checkbox"/>	<input type="checkbox"/>	<input checked="" type="checkbox"/>	10) Central vacuum	<input type="checkbox"/>	<input type="checkbox"/>	<input checked="" type="checkbox"/>
6) Fireplace/chimney	<input type="checkbox"/>	<input type="checkbox"/>	<input checked="" type="checkbox"/>	11) Built in appliances	<input type="checkbox"/>	<input checked="" type="checkbox"/>	<input type="checkbox"/>
7) Lawn sprinkler	<input type="checkbox"/>	<input type="checkbox"/>	<input checked="" type="checkbox"/>	12) Other mechanical systems	<input type="checkbox"/>	<input type="checkbox"/>	<input checked="" type="checkbox"/>

If the answer to any of the above questions is "Yes", please describe and indicate any repairs to the mechanical system (but not longer than the past 5 years): _____

H) PRESENCE OF HAZARDOUS MATERIALS: Do you know of the previous or current presence of any of the below identified hazardous materials on the property?

	Yes	No	Unknown
1) Lead-Based Paint	<input type="checkbox"/>	<input type="checkbox"/>	<input checked="" type="checkbox"/>
2) Asbestos	<input type="checkbox"/>	<input type="checkbox"/>	<input checked="" type="checkbox"/>
3) Urea-Formaldehyde Foam Insulation	<input type="checkbox"/>	<input type="checkbox"/>	<input checked="" type="checkbox"/>
4) Radon Gas	<input type="checkbox"/>	<input type="checkbox"/>	<input checked="" type="checkbox"/>
a. If "Yes", indicate level of gas if known _____			
5) Other toxic or hazardous substances	<input type="checkbox"/>	<input type="checkbox"/>	<input checked="" type="checkbox"/>

If the answer to any of the above questions is "Yes", please describe and indicate any repairs, remediation or mitigation to the property: _____

Owner's Initials LM Date 3/19/15
Owner's Initials _____ Date _____

Purchaser's Initials _____ Date _____
Purchaser's Initials _____ Date _____

POA HAS NEVER LIVED in this property.

Property Address 319 2nd Ave SW Beach City

I) UNDERGROUND STORAGE TANKS/WELLS: Do you know of any underground storage tanks (existing or removed), oil or natural gas wells (plugged or unplugged), or abandoned water wells on the property? Yes No
If "Yes", please describe: _____

Do you know of any oil, gas, or other mineral right leases on the property? Yes No

Purchaser should exercise whatever due diligence purchaser deems necessary with respect to oil, gas, and other mineral rights. Information may be obtained from records contained within the recorder's office in the county where the property is located.

J) FLOOD PLAIN/LAKE ERIE COASTAL EROSION AREA: Yes No Unknown
Is the property located in a designated flood plain?
Is the property or any portion of the property included in a Lake Erie Coastal Erosion Area?

K) DRAINAGE/EROSION: Do you know of any previous or current flooding, drainage, settling or grading or erosion problems affecting the property? Yes No
If "Yes", please describe and indicate any repairs, modifications or alterations to the property or other attempts to control any problems (but not longer than the past 5 years): _____

L) ZONING/CODE VIOLATIONS/ASSESSMENTS/HOMEOWNERS' ASSOCIATION: Do you know of any violations of building or housing codes, zoning ordinances affecting the property or any nonconforming uses of the property? Yes No
If "Yes", please describe: _____

Is the structure on the property designated by any governmental authority as a historic building or as being located in a historic district? (NOTE: such designation may limit changes or improvements that may be made to the property). Yes No
If "Yes", please describe: _____

Do you know of any recent or proposed assessments, fees or abatelements, which could affect the property? Yes No
If "Yes", please describe: _____

List any assessments paid in full (date/amount) _____
List any current assessments: _____ monthly fee _____ Length of payment (years _____ months _____)

Do you know of any recent or proposed rules or regulations of, or the payment of any fees or charges associated with this property, including but not limited to a Community Association, SID, CID, LID, etc. Yes No
If "Yes", please describe (amount): _____

M) BOUNDARY LINES/ENCROACHMENTS/SHARED DRIVEWAY/PARTY WALLS: Do you know of any of the following conditions affecting the property? Yes No Yes No

1) Boundary Agreement	<input type="checkbox"/>	<input checked="" type="checkbox"/>	4) Shared Driveway	<input type="checkbox"/>	<input checked="" type="checkbox"/>
2) Boundary Dispute	<input type="checkbox"/>	<input checked="" type="checkbox"/>	5) Party Walls	<input type="checkbox"/>	<input checked="" type="checkbox"/>
3) Recent Boundary Change	<input type="checkbox"/>	<input checked="" type="checkbox"/>	6) Encroachments From or on Adjacent Property	<input type="checkbox"/>	<input checked="" type="checkbox"/>

If the answer to any of the above questions is "Yes", please describe: _____

N) OTHER KNOWN MATERIAL DEFECTS: The following are other known material defects in or on the property:

For purposes of this section, material defects would include any non-observable physical condition existing on the property that could be dangerous to anyone occupying the property or any non-observable physical condition that could inhibit a person's use of the property.

Owner's Initials JM Date 3/19/15
Owner's Initials _____ Date _____

Purchaser's Initials _____ Date _____
Purchaser's Initials _____ Date _____

POA has never lived in this property

Property Address 319 2nd Ave SW Beach City

CERTIFICATION OF OWNER

Owner certifies that the statements contained in this form are made in good faith and based on his/her actual knowledge as of the date signed by the Owner. Owner is advised that the information contained in this disclosure form does not limit the obligation of the owner to disclose an item of information that is required by any other statute or law or that may exist to preclude fraud, either by misrepresentation, concealment or nondisclosure in a transaction involving the transfer of residential real estate.

OWNER: John J. Miller DATE: 3/19/15
OWNER: _____ DATE: _____

RECEIPT AND ACKNOWLEDGEMENT OF POTENTIAL PURCHASERS

Potential purchasers are advised that the owner has no obligation to update this form but may do so according to Revised Code Section 5302.30(G). Pursuant to Ohio Revised Code Section 5302.30(K), if this form is not provided to you prior to the time you enter into a purchase contract for the property, you may rescind the purchase contract by delivering a signed and dated document of rescission to Owner or Owner's agent, provided the document of rescission is delivered prior to all three of the following dates: 1) the date of closing; 2) 30 days after the Owner accepted your offer; and 3) within 3 business days following your receipt or your agent's receipt of this form or an amendment of this form.

Owner makes no representations with respect to any offsite conditions. Purchaser should exercise whatever due diligence purchaser deems necessary with respect to offsite issues that may affect purchaser's decision to purchase the property.

Purchaser should exercise whatever due diligence purchaser deems necessary with respect to Ohio's Sex Offender Registration and Notification Law (commonly referred to as "Megan's Law"). This law requires the local Sheriff to provide written notice to neighbors if a sex offender resides or intends to reside in the area. The notice provided by the Sheriff is a public record and is open to inspection under Ohio's Public Records Law. If concerned about this issue, purchaser assumes responsibility to obtain information from the Sheriff's office regarding the notices they have provided pursuant to Megan's Law.

Purchaser should exercise whatever due diligence purchaser deems necessary with respect to abandoned underground mines. If concerned about this issue, purchaser assumes responsibility to obtain information from the Ohio Department of Natural Resources. The Department maintains an online map of known abandoned underground mines on their website at www.dnr.state.oh.us.

I/WE ACKNOWLEDGE RECEIPT OF A COPY OF THIS DISCLOSURE FORM AND UNDERSTAND THAT THE STATEMENTS ARE MADE BASED ON THE OWNERS ACTUAL KNOWLEDGE AS OF THE DATE SIGNED BY THE OWNER.

My/Our Signature below does not constitute approval of any disclosed condition as represented herein by the owner.

PURCHASER: _____ DATE: _____
PURCHASER: _____ DATE: _____

POA Has never lived in this property.



AGENCY DISCLOSURE STATEMENT



The real estate agent who is providing you with this form is required to do so by Ohio law. You will not be bound to pay the agent or the agent's brokerage by merely signing this form. Instead, the purpose of this form is to confirm that you have been advised of the role of the agent(s) in the transaction proposed below. (For purposes of this form, the term "seller" includes a landlord and the term "buyer" includes a tenant.)

Property Address: 319 2nd Ave SW - Beach City

Buyer(s): _____

Seller(s): Slayman / Miller P.O.A.

I. TRANSACTION INVOLVING TWO AGENTS IN TWO DIFFERENT BROKERAGES

The buyer will be represented by _____, and _____
AGENT(S) BROKERAGE

The seller will be represented by _____, and _____
AGENT(S) BROKERAGE

II. TRANSACTION INVOLVING TWO AGENTS IN THE SAME BROKERAGE

If two agents in the real estate brokerage _____ represent both the buyer and the seller, check the following relationship that will apply:

- Agent(s) _____ work(s) for the buyer and Agent(s) _____ work(s) for the seller. Unless personally involved in the transaction, the broker and managers will be "dual agents", which is further explained on the back of this form. As dual agents they will maintain a neutral position in the transaction and they will protect all parties' confidential information.
- Every agent in the brokerage represents every "client" of the brokerage. Therefore, agents _____ and _____ will be working for both the buyer and seller as "dual agents". Dual agency is explained on the back of this form. As dual agents they will maintain a neutral position in the transaction and they will protect all parties' confidential information. Unless indicated below, neither the agent(s) nor the brokerage acting as a dual agent in this transaction has a personal, family or business relationship with either the buyer or seller. *If such a relationship does exist, explain:* _____

III. TRANSACTION INVOLVING ONLY ONE REAL ESTATE AGENT

Agent(s) Don Wall, ckr Auctions and real estate brokerage McIntire Realty will

- be "dual agents" representing both parties in this transaction in a neutral capacity. Dual agency is further explained on the back of this form. As dual agents they will maintain a neutral position in the transaction and they will protect all parties' confidential information. Unless indicated below, neither the agent(s) nor the brokerage acting as a dual agent in this transaction has a personal, family or business relationship with either the buyer or seller. *If such a relationship does exist, explain:* _____

represent only the (check one) seller or buyer in this transaction as a client. The other party is not represented and agrees to represent his/her own best interest. Any information provided the agent may be disclosed to the agent's client.

CONSENT

I (we) consent to the above relationships as we enter into this real estate transaction. If there is a dual agency in this transaction, I (we) acknowledge reading the information regarding dual agency explained on the back of this form.

BUYER/TENANT _____ DATE _____

SELLER/LANDLORD J. John J. Miller 3/19/15 DATE

BUYER/TENANT _____ DATE _____

SELLER/LANDLORD _____ DATE _____

Disclosure of Information on Lead-Based Paint and/or Lead-Based Paint Hazards

Property Address 319 2nd Ave SW Beach City

Lead Warning Statement

Every purchaser of any interest in residential real property on which a residential dwelling was built prior to 1978 is notified that such property may present exposure to lead from lead-based paint that may place young children at risk of developing lead poisoning. Lead poisoning in young children may produce permanent neurological damage, including learning disabilities, reduced intelligence quotient, behavioral problems, and impaired memory. Lead poisoning also poses a particular risk to pregnant women. The seller of any interest in residential real property is required to provide the buyer with any information on lead-based paint hazards from risk assessments or inspections in the seller's possession and notify the buyer of any known lead-based paint hazards. A risk assessment or inspection for possible lead-based paint hazards is recommended prior to purchase.

Seller's Disclosure

- (a) Presence of lead-based paint and/or lead-based paint hazards (check (i) or (ii) below):
 - (i) Known lead-based paint and/or lead-based paint hazards are present in the housing (explain).
 - (ii) Seller has no knowledge of lead-based paint and/or lead-based paint hazards in the housing.
- (b) Records and reports available to the seller (check (i) or (ii) below):
 - (i) Seller has provided the purchaser with all available records and reports pertaining to lead-based paint and/or lead-based paint hazards in the housing (list documents below).
 - (ii) Seller has no reports or records pertaining to lead-based paint and/or lead-based paint hazards in the housing.

Purchaser's Acknowledgment (initial)

- (c) Purchaser has received copies of all information listed above.
- (d) Purchaser has received the pamphlet *Protect Your Family from Lead in Your Home*.
- (e) Purchaser has (check (i) or (ii) below):
 - (i) received a 10-day opportunity (or mutually agreed upon period) to conduct a risk assessment or inspection for the presence of lead-based paint and/or lead-based paint hazards; or
 - (ii) waived the opportunity to conduct a risk assessment or inspection for the presence of lead-based paint and/or lead-based paint hazards.

Agent's Acknowledgment (initial)

- (f) JW Agent has informed the seller of the seller's obligations under 42 U.S.C. 4852(d) and is aware of his/her responsibility to ensure compliance.

Certification of Accuracy

The following parties have reviewed the information above and certify, to the best of their knowledge, that the information they have provided is true and accurate.

<input checked="" type="checkbox"/> <u>John J. Walker</u>	<u>3/19/15</u>	_____	_____
Seller	Date	Seller	Date
_____	_____	_____	_____
Purchaser	Date	Purchaser	Date
<input checked="" type="checkbox"/> <u>JW</u>	<u>3/19/15</u>	_____	_____
Agent	Date	Agent	Date

Auction Conducted By:
Don R. Wallick Auctions, Inc.
Auctioneers: Don R. Wallick
Brennan R. Wallick
Ryan W. Wallick

Don R. Wallick Auctions, Inc.
955 N. Wooster Avenue
Stressburg, Ohio 44880
info@WallickAuctions.com
http://www.WallickAuctions.com



Toll Free: 1-888-348-9445 - Tel: 330-676-0075 - Fax: 330-676-7218