

## Data For Parcel 7000522

[Please click here to go to the 2012 Informal Review for Parcel 7000522](#)

[Base](#) [Land](#) [Valuation](#) [Sales](#) [Tax](#) [Building](#) [Improvements](#) [Pictometry](#)

### Base Data

Parcel:	7000522
Owner:	LAUBSCHER ETHEL C
Site Address:	366 TUSCARAWAS AVE NW BREWSTER OH 44613-1032
Map Routing Number:	70 002 03 1500
Tax Map:	<a href="#">BRE_002.pdf</a>



[+] Map this property.

### Tax Mailing Address - Data as of 8/15/2012

Address:	LAUBSCHER ETHEL C
	366 TUSCARAWAS AVE
	BREWSTER OH 44613

### Geographic Information - Data as of 8/15/2012

Tax District:	00670 SUGARCREEK TOWNSHIP-BREWSTER VILLAGE-FAIRLESS LSD
School District:	7604 FAIRLESS LSD
City/Village:	BREWSTER VILLAGE
Township:	SUGARCREEK TOWNSHIP
Neighborhood ID:	070-00-00-01

### Legal - Data as of 8/15/2012

Legal Description:	111.2 WH	Property Class:	RESIDENTIAL
DTE Classification:	510 - 1-FAMILY DWELLING	Listed By:	LEX
Last Inspected:	01/01/2012	Source of Information:	PICTOMETRY
Reviewed By:	GKI	Total Tax Rate (in Mills):	73.000
Reviewed Date:	08/26/2005	Effective Tax Rate (in Mills):	51.198397

### Allotments - Data as of 8/15/2012

No allotment data found for this parcel.

### Parcel History - Data as of 8/15/2012

No history data found for this parcel.

## Data For Parcel 7000522

Please click [here](#) to go to the 2012 Informal Review for Parcel 7000522

[Base](#)
[Land](#)
[Valuation](#)
[Sales](#)
[Tax](#)
[Building](#)
[Improvements](#)
[Pictometry](#)

### Land Data

Parcel:	7000522
Owner:	LAUBSCHER ETHEL C
Site Address:	366 TUSCARAWAS AVE NW BREWSTER OH 44613-1032
Map Routing Number:	70 002 03 1500
Tax Map:	<a href="#">BRE_002.pdf</a>



[+] Map this property.

### Land Detail - Data as of 8/15/2012

Code	Description	Acreage	Frontage	Depth	SF Area	Method	Rate	Adj Reason	Adj Percent	Market Value	Override Value
01	HOUSE LOT		50	150	7,500	FF	\$390.00		0	\$15,600	

### CAUV - Data as of 8/15/2012

Year	Deferred Land Value	Deferred Assessed Value	Tax Savings
2011	\$0	\$0	\$0
2010	\$0	\$0	\$0
2009	\$0	\$0	\$0

Copyright ©2007 Digital Data Technologies, Inc.

## Data For Parcel 7000522

[Please click here to go to the 2012 Informal Review for Parcel 7000522](#)

[Base](#)
[Land](#)
[Valuation](#)
[Sales](#)
[Tax](#)
[Building](#)
[Improvements](#)
[Pictometry](#)

### Valuation Data

Parcel:	7000522
Owner:	LAUBSCHER ETHEL C
Site Address:	366 TUSCARAWAS AVE NW BREWSTER OH 44613-1032
Map Routing Number:	70 002 03 1500
Tax Map:	<a href="#">BRE_002.pdf</a>



[+] Map this property.

### Valuation - Data as of 8/15/2012

Year	Appraised Land Value	Assessed (35%) Land Value	Appraised Building Value	Assessed (35%) Building Value	Appraised Total Value	Assessed (35%) Total Value
2011	\$16,800	\$5,880	\$62,600	\$21,910	\$79,400	\$27,790
2010	\$16,800	\$5,880	\$62,600	\$21,910	\$79,400	\$27,790
2009	\$16,800	\$5,880	\$62,600	\$21,910	\$79,400	\$27,790
2008	\$16,800		\$65,900		\$82,700	\$28,950

### Appeals - Data as of 8/15/2012

No appeals found for this parcel.

### Value Change Reason - Data as of 8/15/2012

Change Reason	Change Date
12 - REAPPRAISAL, UPDATE OR ANNUAL EQUALIZATION	01/09/2001

Copyright ©2007 Digital Data Technologies, Inc.

## Data For Parcel 7000522

[Please click here to go to the 2012 Informal Review for Parcel 7000522](#)

[Base](#)
[Land](#)
[Valuation](#)
[Sales](#)
[Tax](#)
[Building](#)
[Improvements](#)
[Pictometry](#)

If you have any questions regarding the actual payments on this parcel, please call the Treasurer's office at 330-451-7814. Check previous years' taxes on the Stark County Treasurer's site. Use the Stark County Tax Estimator.

### Tax Data

Parcel:	7000522
Owner:	LAUBSCHER ETHEL C
Site Address:	365 TUSCARAWAS AVE NW BREWSTER OH 44613-1032
Map Routing Number:	70 002 03 1500
Tax Map:	BRE_002.pdf



[+] Map this property.

### Tax Information - Data as of 8/15/2012

Bill Number:	20117400082	Installment Number:	2
Taxable Land Value:	\$5,880	Taxable Building Value:	\$21,910
Residential Discount (2.5%):	YES	Homestead Reduction:	YES
CAUV Recoupment:	N/A	Recoupment Amount:	
Homestead Deduction:	\$8,750	Tax Abatement:	NO
TPF Qualified Value:	\$27,790	Property Destruction:	NO
Homestead Deduction Year:	2009	Agricultural Use Value:	NO
Tax Year:	2011		

### Tax Billing - Data as of 8/15/2012

Label	Amount
REAL ESTATE TAX	\$1,014.34
TAX REDUCTION	(\$302.94)
10% ROLLBACK	(\$71.14)
2.5% DISCOUNT	(\$17.79)
HOMESTEAD REDUCTION	(\$195.99)
CURRENT HALF TAX:	\$426.48
27 MUSKINGUM WATERSHED	\$6.00
TOTAL TAX:	\$432.48
AMOUNT DUE:	\$0.00

### Tax Payments - Data as of 8/15/2012

Payment Date	Payment Half	Payment Amount
01/26/2012	1	\$864.96

### Special Assessments - Data as of 8/15/2012

Agency	Code	StandardAmount	Status	Type	Balance
MUSKINGUM WCD	27 - MUSKINGUM WATERSHED	\$6.00	PAID IN FULL	SEMI-ANNUAL FIXED	\$0.00

MUSKINGUM WCD	27 - MUSKINGUM WATERSHED	\$6.00	PAID IN FULL	SEMI-ANNUAL FIXED	\$0.00
Copyright ©2007 Digital Data Technologies, Inc.					

## Data For Parcel 7000522

Please click here to go to the 2012 Informal Review for Parcel 7000522

[Base](#)
[Land](#)
[Valuation](#)
[Sales](#)
[Tax](#)
[Building](#)
[Improvements](#)
[Pictometry](#)

### Building Data

Parcel:	7000522
Owner:	LAUBSCHER ETHEL C
Site Address:	366 TUSCARAWAS AVE NW BREWSTER OH 41613-1032
Map Routing Number:	70 002 03 1500
Tax Map:	<a href="#">BRE_002.pdf</a>



[+] Map this property.

### Buildings - Data as of 8/15/2012

	Building ID	Is Primary	Description	Year Built	Living Area	Bedrooms	Full Baths	Half Baths	Primary Value
Select	7778990	TRUE	10 - SINGLE FAMILY	1922	1,756	3	2	0	\$46,500

### Building Detail - Data as of 8/15/2012

Building ID:	7778990	Actual Year Built:	1922
Building Type:	10 - SINGLE FAMILY	Effective Year Built:	1922
No. Stories:	2.00	Condition:	3 - AVERAGE
Living Area (sqft):	1,756	Quality Grade:	100
No. Bedrooms:	3	Construction Type:	1 - WOOD FRAME
Quality Basement Finish:	0 - NONE	Central Air:	YES
Heat Type:	GAS	Half Baths:	0
Full Baths:	2	No. Fireplaces:	1
Basement:	1 - FULL	Primary Value:	\$46,500
Family Room:	NO	Override Value:	NOT AVAILABLE
Percent Complete:	100		

### Sketch - Data as of 8/15/2012

For a list of sketch codes and descriptions, download [this list](#).

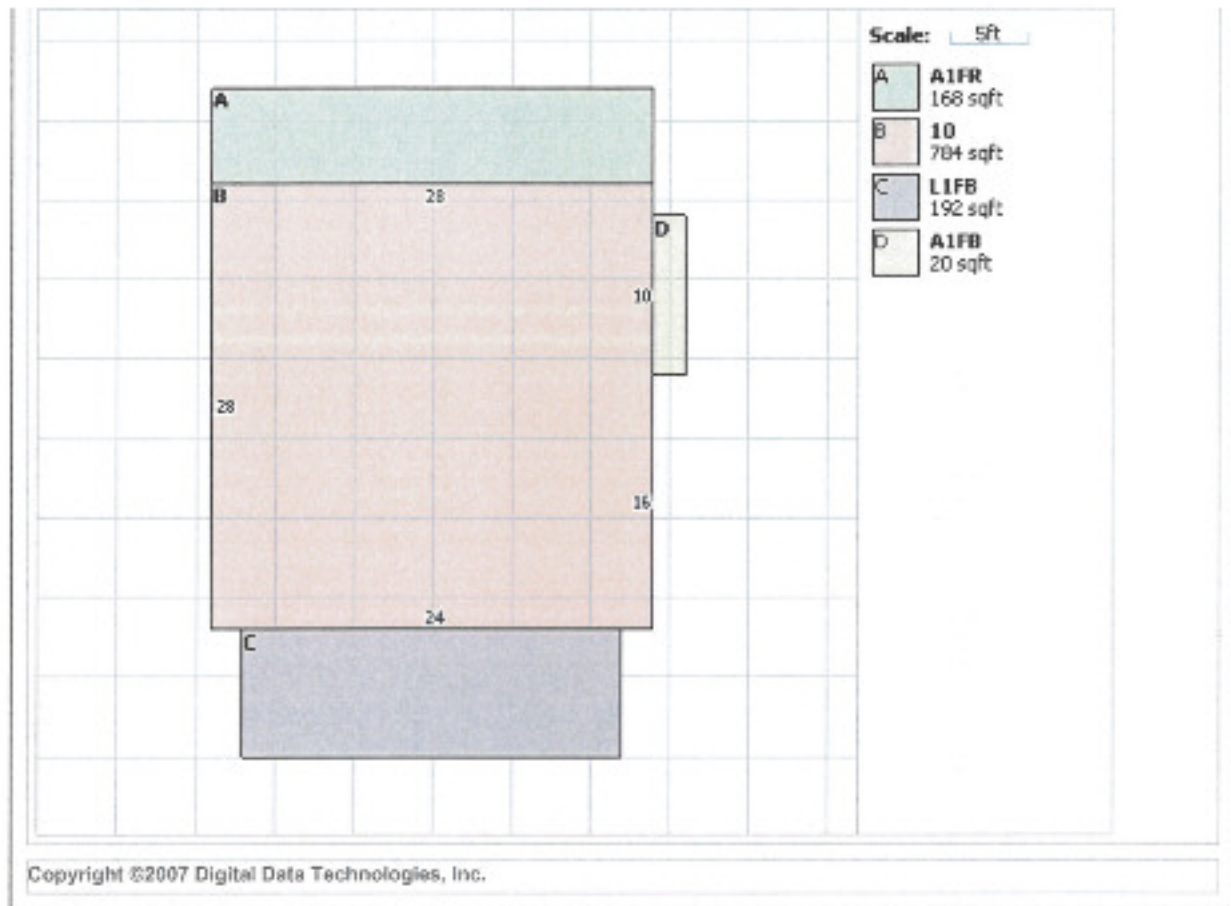

## Data For Parcel 7000522

[Please click here to go to the 2012 Informal Review for Parcel 7000522](#)

[Base](#)
[Land](#)
[Valuation](#)
[Sales](#)
[Tax](#)
[Building](#)
[Improvements](#)
[Pictometry](#)

### Improvement Data

Parcel:	7000522
Owner:	LAUBSCHER ETHEL C
Site Address:	366 TUSCARAWAS AVE NW BREWSTER OH 44613-1032
Map Routing Number:	70 002 03 1500
Tax Map:	<a href="#">BRE_002.pdf</a>



[+] Map this property.

### Improvements - Data as of 8/15/2012

	Improvement ID	Description	Year Built	Area	Grade	Condition	Value
Select	6359757	140 - GARAGE	1922	240	80	AVERAGE	1,000

### Improvement Detail - Data as of 8/15/2012

Improvement ID:	6359757	Percent Complete:	100
Building Type:	140 - GARAGE	Common Walls:	0
Number of Stories:	1.0	Construction Type:	WOOD FRAME
Frontage:	12.00	Depth:	20
Area:	240	Year Built:	1922
Height:	0	Condition:	AVERAGE
Function Adj Percent:	0	Economic Adj Percent:	0
Function Adj Reason:	-	Economic Adj Reason:	0 - LEGACY
Value:	1,000	Grade:	80
Override Value:			

Copyright ©2007 Digital Data Technologies, Inc.



## Data For Parcel 7000522

[Please click here to go to the 2012 Informal Review for Parcel 7000522](#)

[Base](#) [Land](#) [Valuation](#) [Sales](#) [Tax](#) [Building](#) [Improvements](#) [Pictometry](#)

### Pictometry Data

Parcel:	7000522
Owner:	LAUBSCHER ETHEL C
Site Address:	356 TUSCARAWAS AVE NW BREWSTER OH 46113-1032
Map Routing Number:	70 002 03 1500
Tax Map:	<a href="#">BRE_002.pdf</a>



[+] Map this property.

Direction: [North](#) [East](#) [South](#) [West](#) Zoom: [In](#) [Out](#)



Copyright ©2007 Digital Data Technologies, Inc.

Property Record Card - Alan Harold, Stark County Auditor

Generated 9/5/2012 8:06:34 PM

Subject Property	
Parcel	7000522
Owner	LAUBSCHER ETHEL C
Address	366 TUSCARAWAS AVE NW BREWSTER OH 44613-1032
Mailing Address Line 1	LAUBSCHER ETHEL C
Mailing Address Line 2	366 TUSCARAWAS AVE
Mailing Address Line 3	BREWSTER OH 44613
Legal Description	1112 WH
Last Inspected	01/01/2012
Property Class	RESIDENTIAL
DTE Classification	510 - 1-FAMILY DWELLING
Tax District	00670 SUGARCREEK TOWNSHIP-BREWSTER VILLAGE-FAIRLESS LSD
School District	7604 FAIRLESS LSD
Township	SUGARCREEK TOWNSHIP
City	BREWSTER VILLAGE
Neighborhood	073-00-00-01
Map Routing Number	70 002 03 1500

Allotments	
Allotment	Lot
No Allotment Information Available	

Valuation Details						
Year	Appraised Land Value	Assessed Land Value	Appraised Building Value	Assessed Building Value	Appraised Total Value	Assessed Total Value
2011	\$16,800	\$5,880	\$62,600	\$21,910	\$79,400	\$27,790
2010	\$16,800	\$5,880	\$62,600	\$21,910	\$79,400	\$27,790
2009	\$16,800	\$5,880	\$62,600	\$21,910	\$79,400	\$27,790
2008	\$16,800		\$65,900		\$82,700	\$28,960

Land Details								
Description	Acreage	Frontage	Depth	Area (sqft)	Method	Rate	Adj %	Value
HOUSE LOT		50	150	7,500	FF	\$390.00	0	\$15,800

Sales Details						
Date	Work Order Number	Work Order Year	Number Of Parcels	Arms Length	Sale Price	Taxable Value
1/29/2007	1033	2007	0	NO	\$0	\$29,950

Details for Primary Building 7778980					
Building Type	10 - SINGLE FAMILY	Construction Type	1 - WOOD FRAME	Full Baths	2
Year Built	1922	Quality Basement Finish	0 - NONE	Half Baths	0
Number Of Stories	2.00	Percent Complete	100	Basement	1 - FULL
Condition	3 - AVERAGE	Heat Type	GAS	Number Of Fireplaces	1
Living Area	1755	Central Air	YES	Family Room	NO
Quality Grade	100	Number Of Bedrooms	3	Primary Value	\$46,500

**Details for Improvement 6350757**

Building Type	140 - GARAGE	Adjustment Percent	0	Year Built	1922
Number Of Stories	1.0	Value	1,000	Reason	-
Frontage	12.00	Common Walls	0	Condition	AVERAGE
Depth	20	Construction Type	WOOD FRAME	Grade	80
Area (sqft)	240	Height	0	Value	1,000



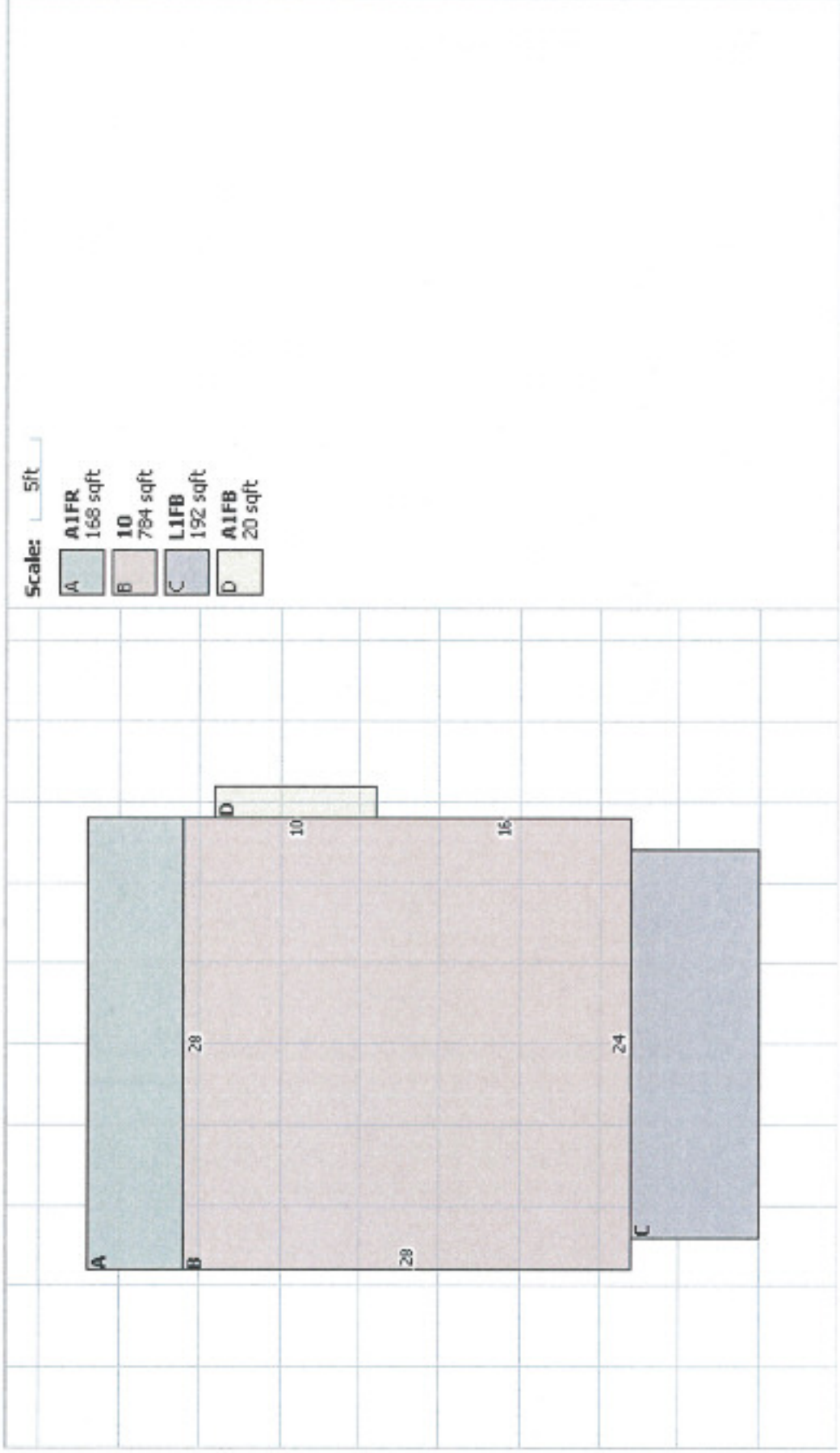

7000522 Building ID 7778990



11/6/08

STATE OF OHIO  
DEPARTMENT OF COMMERCE

RESIDENTIAL PROPERTY DISCLOSURE FORM

Pursuant to section 5302.30 of the Revised Code and rule 1301.5-6-10 of the Administrative Code.

TO BE COMPLETED BY OWNER (Please Print)

Property Address: 366 TASCARAWAS AVE. NW

REWSTER, OHIO 44613

Owner's Name(s): PAUL LAUBACHER (TOA)

Date: \_\_\_\_\_, 20\_\_\_\_

Owner is  is not occupying the property. If owner is occupying the property, since what date: \_\_\_\_\_

**Purpose of Disclosure Form:** This is a statement of the condition of the property and of information concerning the property actually known by the owner as required by Ohio Revised Code Section 5302.30. Unless otherwise advised in writing by the owner, the owner, other than having lived at or owning the property, possesses no greater knowledge than that which could be obtained by a careful inspection of the property by a potential purchaser. Unless otherwise advised, owner has not conducted any inspection of generally inaccessible areas of the property. THIS STATEMENT IS NOT A WARRANTY OF ANY KIND BY THE OWNER OR BY ANY AGENT OR SUBAGENT REPRESENTING THE OWNER OF THE PROPERTY. THIS STATEMENT IS NOT A SUBSTITUTE FOR ANY INSPECTIONS. POTENTIAL PURCHASERS ARE ENCOURAGED TO OBTAIN THEIR OWN PROFESSIONAL INSPECTION.

**Owner's Statement:** The representations contained on this form are made by the owner and are not the representations of the owner's agent or subagent. This form and the representations contained in it are provided by the owner exclusively to potential purchasers in a transfer made by the owner, and are not made to purchasers in any subsequent transfers. The information contained in this disclosure form does not limit the obligation of the owner to disclose an item of information that is required by any other statute or law to be disclosed in the transfer of residential real estate. For example, although some questions are limited to the past five years material problems or defects that occurred over five years ago that have not been fully corrected are required to be disclosed.

**Instructions to Owner:** (1) Answer ALL questions. (2) Identify any material matters in the property that are actually known. (3) Attach additional pages with your signature if additional space is needed. (4) Complete this form yourself. (5) If some items do not apply to your property, write NA (not applicable). If the item to be disclosed is not within your actual knowledge, indicate Unknown.

THE FOLLOWING STATEMENTS OF THE OWNER ARE BASED ON OWNER'S ACTUAL KNOWLEDGE

- A) WATER SUPPLY: The source of water supply to the property is (check appropriate boxes):
- |  |                                       |                                      |
|--|---------------------------------------|--------------------------------------|
| <input checked="" type="checkbox"/> Public Water Service | <input type="checkbox"/> Holding Tank | <input type="checkbox"/> Unknown     |
| <input type="checkbox"/> Private Water Service           | <input type="checkbox"/> Cistern      | <input type="checkbox"/> Other _____ |
| <input type="checkbox"/> Private Well                    | <input type="checkbox"/> Spring       | _____                                |
| <input type="checkbox"/> Shared Well                     | <input type="checkbox"/> Pond         | _____                                |

Do you know of any current leaks, backups or other material problems with the water supply system or quality of the water?  
 Yes  No If "Yes", please describe: \_\_\_\_\_

Is the quantity of water sufficient for your household use? (NOTE: water usage will vary from household to household)  Yes  No  
If owner knows of any leaks, backups or other material problems with the water supply system or quality or quantity of the water since owning the property (but not longer than the past 5 years), please describe and indicate any repairs completed: \_\_\_\_\_

Owner's Initials PL Date 3/16/12 Purchaser's Initials \_\_\_\_\_ Date \_\_\_\_\_

Property Address 366 YUSCARAWAS AVE. NW BREWSTER, OHIO 44613

B) SEWER SYSTEM: The nature of the sanitary sewer system servicing the property is (check appropriate boxes):

- |  |  |   |
|--|--|---|
| <input checked="" type="checkbox"/> Public Sewer | <input type="checkbox"/> Private Sewer | <input type="checkbox"/> Septic Tank    |
| <input type="checkbox"/> Leach Field             | <input type="checkbox"/> Aeration Tank | <input type="checkbox"/> Filtration Bed |
| <input type="checkbox"/> Unknown                 | <input type="checkbox"/> Other _____   |   |

If not a public or private sewer, date of last inspection: \_\_\_\_\_

Do you know of any current leaks, backups or other material problems with the sewer system servicing the property?  Yes  No

If "Yes", please describe: \_\_\_\_\_

If owner knows of any leaks, backups or other material problems with the sewer system since owning the property (but not longer than the past 5 years), please describe and indicate any repairs completed: \_\_\_\_\_

Information on the operation and maintenance of the type of sewage system serving the property is available from the department of health or the board of health of the health district in which the property is located.

C) ROOF: Do you know of any current leaks or other material problems with the roof or rain gutters?  Yes  No

If "Yes", please describe: \_\_\_\_\_

If owner knows of any leaks or other material problems with the roof or rain gutters since owning the property (but not longer than the past 5 years), please describe and indicate any repairs completed: \_\_\_\_\_

D) WATER INTRUSION: Do you know of any previous or current water leakage, water accumulation, excess moisture or other defects to the property, including but not limited to any area below grade, basement or crawl space?  Yes  No

If "Yes", please describe and indicate any repairs completed: \_\_\_\_\_

Do you know of any water or moisture related damage to floors, walls or ceilings as a result of flooding; moisture seepage; moisture condensation; ice damming; sewer overflow/backlog; or leaking pipes, plumbing fixtures, or appliances?  Yes  No

If "Yes", please describe and indicate any repairs completed: \_\_\_\_\_

Purchaser is advised that every home contains mold. Some people are more sensitive to mold than others. If concerned about this issue, purchaser is encouraged to have a mold inspection done by a qualified inspector. Have you ever had the property inspected for mold by a qualified inspector?

Yes  No If "Yes", please describe and indicate whether you have an inspection report and any remediation undertaken: \_\_\_\_\_

E) STRUCTURAL COMPONENTS (FOUNDATION, BASEMENT/CRAWL SPACE, FLOORS, INTERIOR AND EXTERIOR WALLS):

Do you know of any movement, shifting, deterioration, material cracks/settling (other than visible minor cracks or blemishes) or other material problems with the foundation, basement/crawl space, floors, or interior/exterior walls?

Yes  No If "Yes", please describe: \_\_\_\_\_

If owner knows of any repairs, alterations or modifications to control the cause or effect of any problem identified above, since owning the property (but not longer than the past 5 years), please describe: \_\_\_\_\_

Do you know of any previous or current fire or smoke damage to the property?  Yes  No

If "Yes", please describe and indicate any repairs completed: \_\_\_\_\_

F) MECHANICAL SYSTEMS: Do you know of any current problems or defects with the following mechanical systems? If your property does not have the mechanical system, mark N/A (Not Applicable).

- |                             | YES                      | NO                                  | N/A                                 |                               | YES                      | NO                                  | N/A                                 |
|-----------------------------|--------------------------|-------------------------------------|-------------------------------------|-------------------------------|--------------------------|-------------------------------------|-------------------------------------|
| 1) Electrical               | <input type="checkbox"/> | <input checked="" type="checkbox"/> | <input type="checkbox"/>            | 8) Water softener             | <input type="checkbox"/> | <input checked="" type="checkbox"/> | <input type="checkbox"/>            |
| 2) Plumbing (pipes)         | <input type="checkbox"/> | <input checked="" type="checkbox"/> | <input type="checkbox"/>            | a. Is water softener leased?  | <input type="checkbox"/> | <input checked="" type="checkbox"/> | <input type="checkbox"/>            |
| 3) Central heating          | <input type="checkbox"/> | <input checked="" type="checkbox"/> | <input type="checkbox"/>            | 9) Security System            | <input type="checkbox"/> | <input type="checkbox"/>            | <input checked="" type="checkbox"/> |
| 4) Central Air conditioning | <input type="checkbox"/> | <input checked="" type="checkbox"/> | <input type="checkbox"/>            | a. Is security system leased? | <input type="checkbox"/> | <input type="checkbox"/>            | <input type="checkbox"/>            |
| 5) Sump pump                | <input type="checkbox"/> | <input type="checkbox"/>            | <input checked="" type="checkbox"/> | 10) Central vacuum            | <input type="checkbox"/> | <input type="checkbox"/>            | <input checked="" type="checkbox"/> |
| 6) Fireplace/chimney        | <input type="checkbox"/> | <input checked="" type="checkbox"/> | <input type="checkbox"/>            | 11) Built in appliances       | <input type="checkbox"/> | <input checked="" type="checkbox"/> | <input type="checkbox"/>            |
| 7) Lawn sprinkler           | <input type="checkbox"/> | <input type="checkbox"/>            | <input checked="" type="checkbox"/> | 12) Other mechanical systems  | <input type="checkbox"/> | <input type="checkbox"/>            | <input checked="" type="checkbox"/> |

If the answer to any of the above questions is "Yes", please describe and indicate any repairs to the mechanical system since owning the property (but not longer than the past 5 years). \_\_\_\_\_

Owner's Initials SR / Date 8/16/12

Purchaser's Initials \_\_\_\_\_ / Date \_\_\_\_\_

Property Address 366 TASCARAWA AVE NW1 BREWSTER, OHIO 44612

**G) WOOD BORING INSECTS/TERMITES:** Do you know of the presence of any wood boring insects/termites in or on the property or any existing damage to the property caused by wood boring insects/termites?  Yes  No

If "Yes", please describe: \_\_\_\_\_

If owner knows of any inspection or treatment for wood boring insects/termites, since owning the property (but not longer than the past 5 years), please describe: \_\_\_\_\_

**H) PRESENCE OF HAZARDOUS MATERIALS:** Do you know of the previous or current presence of any of the below identified hazardous materials on the property?

	Yes	No	Unknown
1) Lead-Based Paint	<input type="checkbox"/>	<input type="checkbox"/>	<input checked="" type="checkbox"/>
2) Asbestos	<input type="checkbox"/>	<input type="checkbox"/>	<input checked="" type="checkbox"/>
3) Urea-Formaldehyde Foam Insulation	<input type="checkbox"/>	<input type="checkbox"/>	<input checked="" type="checkbox"/>
4) Radon Gas	<input type="checkbox"/>	<input type="checkbox"/>	<input checked="" type="checkbox"/>
a. If "Yes", indicate level of gas if known _____			
5) Other toxic or hazardous substances	<input type="checkbox"/>	<input type="checkbox"/>	<input checked="" type="checkbox"/>

If the answer to any of the above questions is "Yes", please describe and indicate any repairs, remediation or mitigation to the property: \_\_\_\_\_

**I) FLOOD PLAIN/LAKE ERIE COASTAL EROSION AREA:**

Is the property located in a designated flood plain?  Yes  No  Unknown

Is the property or any portion of the property included in a Lake Erie Coastal Erosion Area?  Yes  No  Unknown

**J) DRAINAGE/EROSION:** Do you know of any current flooding, drainage, settling or grading or erosion problems affecting the property?  Yes  No

If "Yes", please describe: \_\_\_\_\_

If owner knows of any repairs, modifications or alterations to the property or other attempts to control any flooding, drainage, settling, grading or erosion problems since owning the property (but not longer than the past 5 years), please describe: \_\_\_\_\_

**K) ZONING/CODE VIOLATIONS/ASSESSMENTS/HOME OWNERS ASSOCIATION:** Do you know of any violations of building or housing codes, zoning ordinances affecting the property or any nonconforming uses of the property?  Yes  No

If "Yes", please describe: \_\_\_\_\_

Is the structure on the property designated by any governmental authority as a historic building or as being located in an historic district? (NOTE: such designation may limit changes or improvements that may be made to the property).  Yes  No

If "Yes", please describe: \_\_\_\_\_

Do you know of any recent or proposed assessments, which could affect the property?  Yes  No

If "Yes", please describe: \_\_\_\_\_

Is the property subject to any rules or regulations of, or the payment of any fees or charges to, a Homeowners Association, Condominium Association or any other Community Association?  Yes  No

If "Yes", please describe: \_\_\_\_\_

Owner's Initials Pat 9/16/12 Date \_\_\_\_\_

Purchaser's Initials \_\_\_\_\_ Date \_\_\_\_\_



Property Address 366 TUSCARAWAS AVE. NW BREWSTER OHIO 44613

L) **BOUNDARY LINES/ENCROACHMENTS/SHARED DRIVEWAY/PARTY WALLS:** Do you know of any of the following conditions affecting the property? Yes No

1) Boundary Agreement	<input type="checkbox"/>	<input checked="" type="checkbox"/>	4) Shared Driveway	<input type="checkbox"/>	<input checked="" type="checkbox"/>
2) Boundary Dispute	<input type="checkbox"/>	<input checked="" type="checkbox"/>	5) Party Walls	<input type="checkbox"/>	<input checked="" type="checkbox"/>
3) Recent Boundary Change	<input type="checkbox"/>	<input checked="" type="checkbox"/>	6) Encroachments From or on Adjacent Property	<input type="checkbox"/>	<input checked="" type="checkbox"/>

If the answer to any of the above questions is "Yes", please describe: \_\_\_\_\_

M) **UNDERGROUND STORAGE TANKS/WELLS:** Do you know of any underground storage tanks (existing or removed), oil or natural gas wells (plugged or unplugged), or abandoned water wells on the property?  Yes  No  
If "Yes", please describe: \_\_\_\_\_

N) **OTHER KNOWN MATERIAL DEFECTS:** The following are other known material defects in or on the property: \_\_\_\_\_

For purposes of this section, material defects would include any non-observable physical condition existing on the property that could be dangerous to anyone occupying the property or any non-observable physical condition that could inhibit a person's use of the property.

Owner represents that the statements contained in this form are made in good faith based on his/her actual knowledge as of the date signed by the Owner. Owner is advised that the information contained in this disclosure form does not limit the obligation of the owner to disclose an item of information that is required by any other statute or law or that may exist to preclude fraud, either by misrepresentation, concealment or nondisclosure in a transaction involving the transfer of residential real estate.

OWNER: *Paul L. Linder (POA)* DATE: 8/16/12  
OWNER: \_\_\_\_\_ DATE: \_\_\_\_\_

**RECEIPT AND ACKNOWLEDGEMENT OF POTENTIAL PURCHASERS**

Potential purchasers are advised that the owner has no obligation to update this form but may do so according to Revised Code Section 5302.30(G). Pursuant to Ohio Revised Code Section 5302.30(K), if this form is not provided to you prior to the time you enter into a purchase contract for the property, you may rescind the purchase contract by delivering a signed and dated document of rescission to Owner or Owner's agent, provided the document of rescission is delivered prior to all three of the following dates: 1) the date of closing; 2) 30 days after the Owner accepted your offer; and 3) within 3 business days following your receipt or your agent's receipt of this form or an amendment of this form.

I/WE ACKNOWLEDGE RECEIPT OF A COPY OF THIS DISCLOSURE FORM AND UNDERSTAND THAT THE STATEMENTS ARE MADE BASED ON THE OWNERS ACTUAL KNOWLEDGE AS OF THE DATE SIGNED BY THE OWNER.

Owner makes no representations with respect to any offsite conditions. Purchaser should exercise whatever due diligence purchaser deems necessary with respect to offsite issues that may affect purchaser's decision to purchase the property. Purchaser should exercise whatever due diligence purchaser deems necessary with respect to Ohio's Sex Offender Registration and Notification Law (commonly referred to as "Megan's Law"). This law requires the local Sheriff to provide written notice to neighbors if a sex offender resides or intends to reside in the area. The notice provided by the Sheriff is a public record and is open to inspection under Ohio's Public Records Law. If concerned about this issue, purchaser assumes responsibility to obtain information from the Sheriff's office regarding the notices they have provided pursuant to Megan's Law.

My/Our Signature below does not constitute approval of any disclosed condition as represented herein by the owner.

PURCHASER: \_\_\_\_\_ DATE: \_\_\_\_\_  
PURCHASER: \_\_\_\_\_ DATE: \_\_\_\_\_

Disclosure of Information on Lead-Based Paint and/or Lead-Based Paint Hazards

Property Address 366 TUSCALAWA Ave NW Brewster

**Lead Warning Statement**

Every purchaser of any interest in residential real property on which a residential dwelling was built prior to 1978 is notified that such property may present exposure to lead from lead-based paint that may place young children at risk of developing lead poisoning. Lead poisoning in young children may produce permanent neurological damage, including learning disabilities, reduced intelligence quotient, behavioral problems, and impaired memory. Lead poisoning also poses a particular risk to pregnant women. The seller of any interest in residential real property is required to provide the buyer with any information on lead-based paint hazards from risk assessments or inspections in the seller's possession and notify the buyer of any known lead-based paint hazards. A risk assessment or inspection for possible lead-based paint hazards is recommended prior to purchase.

**Seller's Disclosure**

(a) Presence of lead-based paint and/or lead-based paint hazards (check (i) or (ii) below):

(i)  Known lead-based paint and/or lead-based paint hazards are present in the housing (explain).

(ii)  Seller has no knowledge of lead-based paint and/or lead-based paint hazards in the housing.

(b) Records and reports available to the seller (check (i) or (ii) below):

(i)  Seller has provided the purchaser with all available records and reports pertaining to lead-based paint and/or lead-based paint hazards in the housing (list documents below).

(ii)  Seller has no reports or records pertaining to lead-based paint and/or lead-based paint hazards in the housing.

**Purchaser's Acknowledgment (Initial)**

(c)  Purchaser has received copies of all information listed above.

(d)  Purchaser has received the pamphlet *Protect Your Family from Lead in Your Home*.

(e) Purchaser has (check (i) or (ii) below):

(i)  received a 10-day opportunity (or mutually agreed upon period) to conduct a risk assessment or inspection for the presence of lead-based paint and/or lead-based paint hazards; or

(ii)  waived the opportunity to conduct a risk assessment or inspection for the presence of lead-based paint and/or lead-based paint hazards.

**Agent's Acknowledgment (Initial)**

(f) RW Agent has informed the seller of the seller's obligations under 42 U.S.C. 4852(d) and is aware of his/her responsibility to ensure compliance.

**Certification of Accuracy**

The following parties have reviewed the information above and certify, to the best of their knowledge, that the information they have provided is true and accurate.

[Signature] Seller Date 8/16/12 Seller Date

Purchaser Date Purchaser Date

[Signature] Agent Date 8/16/12 Agent Date



---

**Auction Conducted By:**  
**Don R. Wallick Auctions, Inc.**  
**Auctioneers: Don R. Wallick**  
**Brennan R. Wallick**  
**Ryan W. Wallick**

Don R. Wallick Auctions, Inc.  
865 N. Wooster Avenue  
Sresburg, Ohio 44880  
Info@WallickAuctions.com  
<http://www.WallickAuctions.com>



Toll Free: 1-888-348-9448 - Tel: 330-878-0075 - Fax: 330-878-7318